

# Bixby New Residential Developments

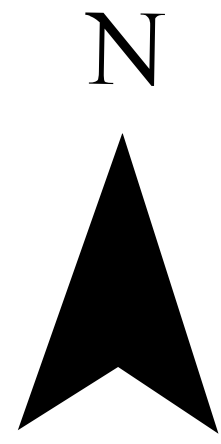

Note: Includes only developments with a significant amount of available lots remaining, those undergoing development, & those "in the planning phase." Not listed: Covenant Place of Tulsa assisted living community.

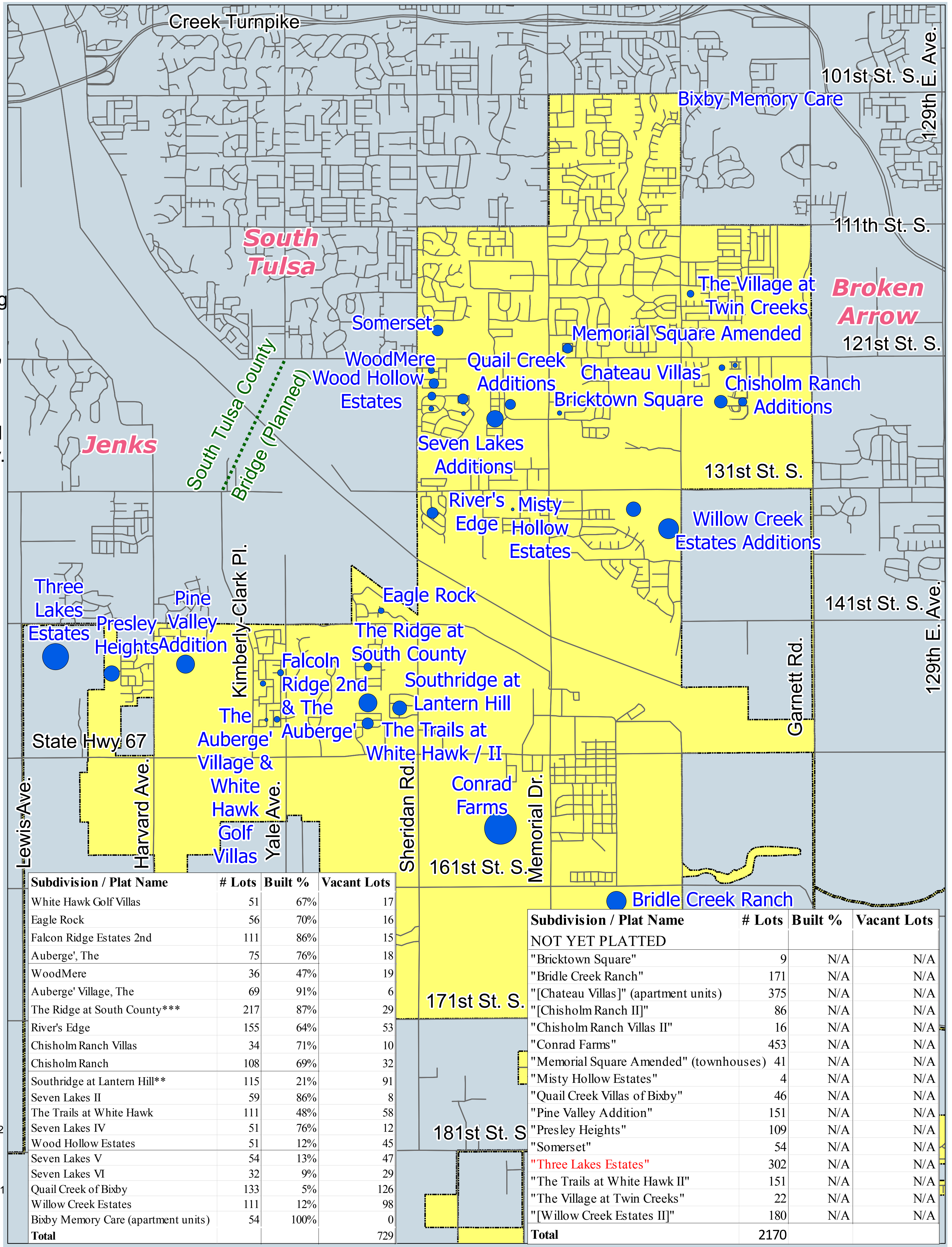

Subdivision / Plat Name	# Lots	Built %	Vacant Lots
White Hawk Golf Villas	51	67%	17
Eagle Rock	56	70%	16
Falcon Ridge Estates 2nd	111	86%	15
Auberge', The	75	76%	18
WoodMere	36	47%	19
Auberge' Village, The	69	91%	6
The Ridge at South County***	217	87%	29
River's Edge	155	64%	53
Chisholm Ranch Villas	34	71%	10
Chisholm Ranch	108	69%	32
Southridge at Lantern Hill**	115	21%	91
Seven Lakes II	59	86%	8
The Trails at White Hawk	111	48%	58
Seven Lakes IV	51	76%	12
Wood Hollow Estates	51	12%	45
Seven Lakes V	54	13%	47
Seven Lakes VI	32	9%	29
Quail Creek of Bixby	133	5%	126
Willow Creek Estates	111	12%	98
Bixby Memory Care (apartment units)	54	100%	0
<b>Total</b>			<b>729</b>

Subdivision / Plat Name	# Lots	Built %	Vacant Lots
<b>NOT YET PLATTED</b>			
"Bricktown Square"	9	N/A	N/A
"Bridle Creek Ranch"	171	N/A	N/A
"[Chateau Villas]" (apartment units)	375	N/A	N/A
"[Chisholm Ranch II]"	86	N/A	N/A
"Chisholm Ranch Villas II"	16	N/A	N/A
"Conrad Farms"	453	N/A	N/A
"Memorial Square Amended" (townhouses)	41	N/A	N/A
"Misty Hollow Estates"	4	N/A	N/A
"Quail Creek Villas of Bixby"	46	N/A	N/A
"Pine Valley Addition"	151	N/A	N/A
"Presley Heights"	109	N/A	N/A
"Somerset"	54	N/A	N/A
"Three Lakes Estates"	302	N/A	N/A
"The Trails at White Hawk II"	151	N/A	N/A
"The Village at Twin Creeks"	22	N/A	N/A
"[Willow Creek Estates II]"	180	N/A	N/A
<b>Total</b>	<b>2170</b>		

- Plats**
- 1
  - 10
  - 100
- WagRoads\_Aug2012
- Bixby\_Streets
- E-911\_Streets
- BA\_Streets\_May2011
- Bixby City Limits

